

# CMUV Common Mode Chokes

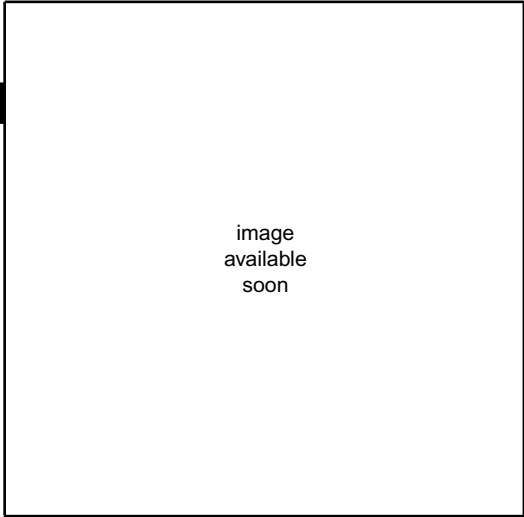

**Features:**

- Section wound for low capacitance and high self resonant frequency
- One-piece core for highest inductance
- Round center bobbin for low DCR
- Compact design for small volume
- 130° C rating (ambient plus rise)

Figure 1

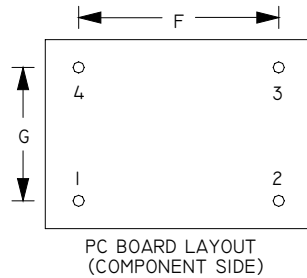
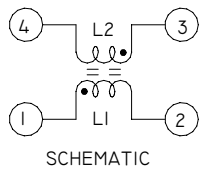
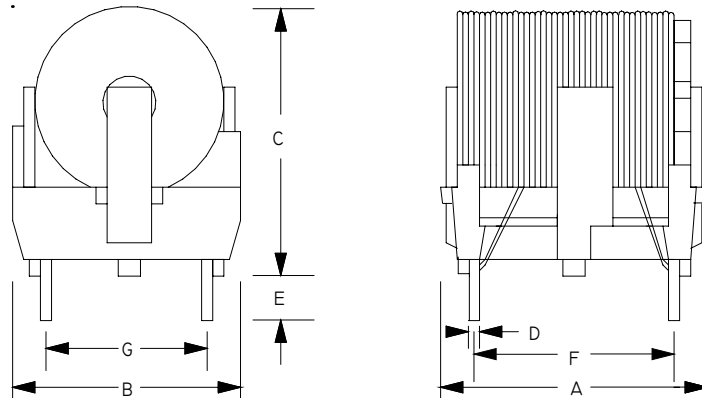

Precision Model Number	Figure Number	Data on Page		A MAX	B MAX	C MAX	D NOM	E NOM	F NOM	G NOM
CMUV-22170-xxxx	1	2	mm	22	17	22	0.8	4.0	13.0	10.0
			in	.866	.670	.866	.031	.157	.512	.394

## CMUV Common Mode Chokes

Precision Model Number	Figure Number	Inductance [uH Min.] <i>(note 1)</i>	DC Resistance [Ohms Max] <i>(note 2)</i>	Rated Current [Amps]	Inductance Difference [uH Max]
CMUV-22170-9001	1	9000	1.40	.50	300
CMUV-22170-4501	1	4500	.75	.60	250
CMUV-22170-2501	1	2500	.40	.70	200
CMUV-22170-1101	1	1100	.25	.90	150
CMUV-22170-4500	1	450	.13	1.00	100

**Note 1:** Inductance measured at 1KHz, 0.1 Vrms, each winding measured separately.

**Note 2:** Each winding measured separately.